

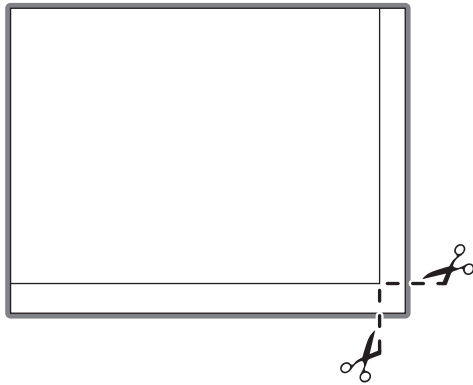



1



Cut along the dashed lines in the bottom corner of each wall.

2

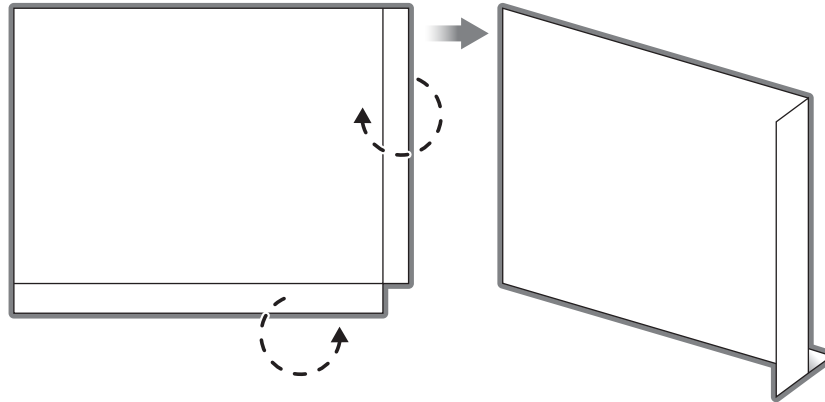

Using the solid lines as guides, fold the longer bottom edge of each wall back and the shorter vertical edge forward.

3

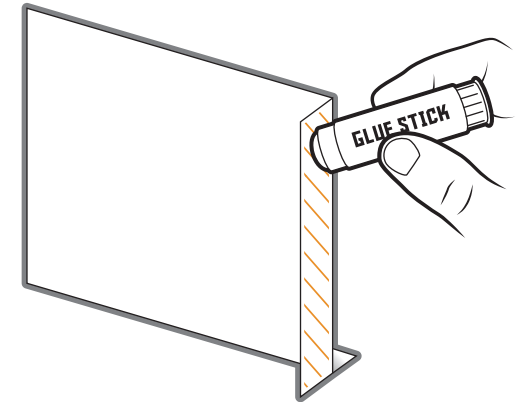

Using a glue stick, glue the vertical edge of one wall on the blank side.

4

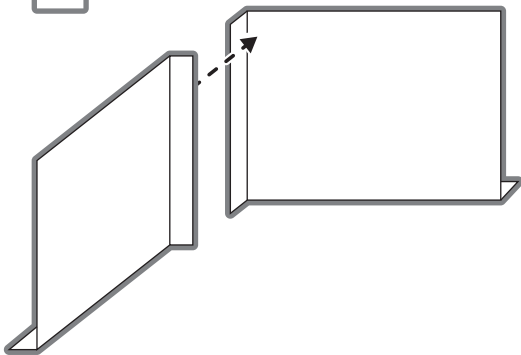

Attach glued wall edge to the inside edge of the opposite wall.

5

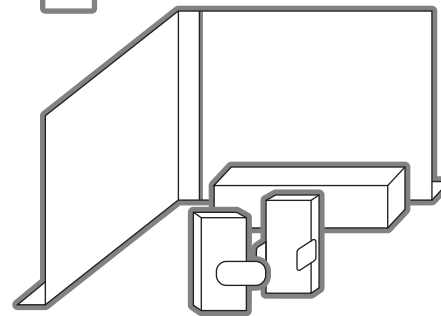

Place assembled accessories and Box Sumo characters into the environment, and you're ready to go!

6

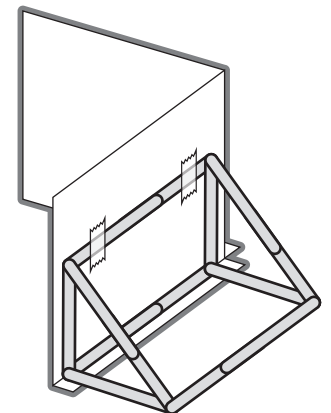

If you want to add extra stability to your walls, you can build supporting frames out of popsicle sticks and attach them to the backside of each wall.